

UYGULAMA TİPLERİ

TİP A

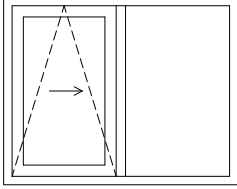

TİP A1

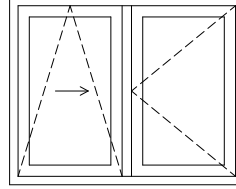

TİP B

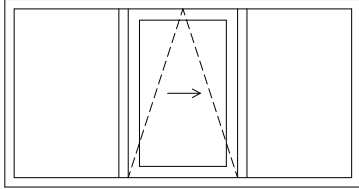

TİP B1

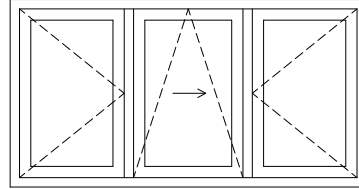

TİP C

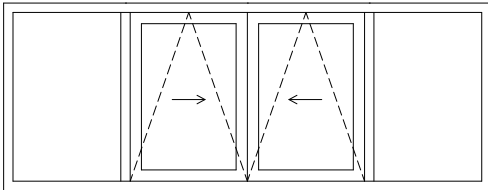

TİP C1

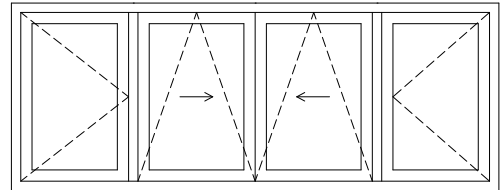

TİP D

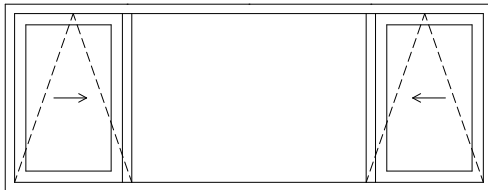

SÜRME+VASİSTAS AÇILIR KAPIYA AİT BİLGİLER

MEKANİZMA: SIEGENIA PSK PORTAL-LM

KANAT GENİŞLİĞİ(KG): MIN 700-1650 mm.

KANAT YÜKSEKLİĞİ(KY): MIN 850-2400 mm.

KANAT AĞIRLIĞI: MAX 150 kg.

MEKANİZMA RENK: NATUREL ELOKSAL

SÜRME-VASİSTAS PENCERE

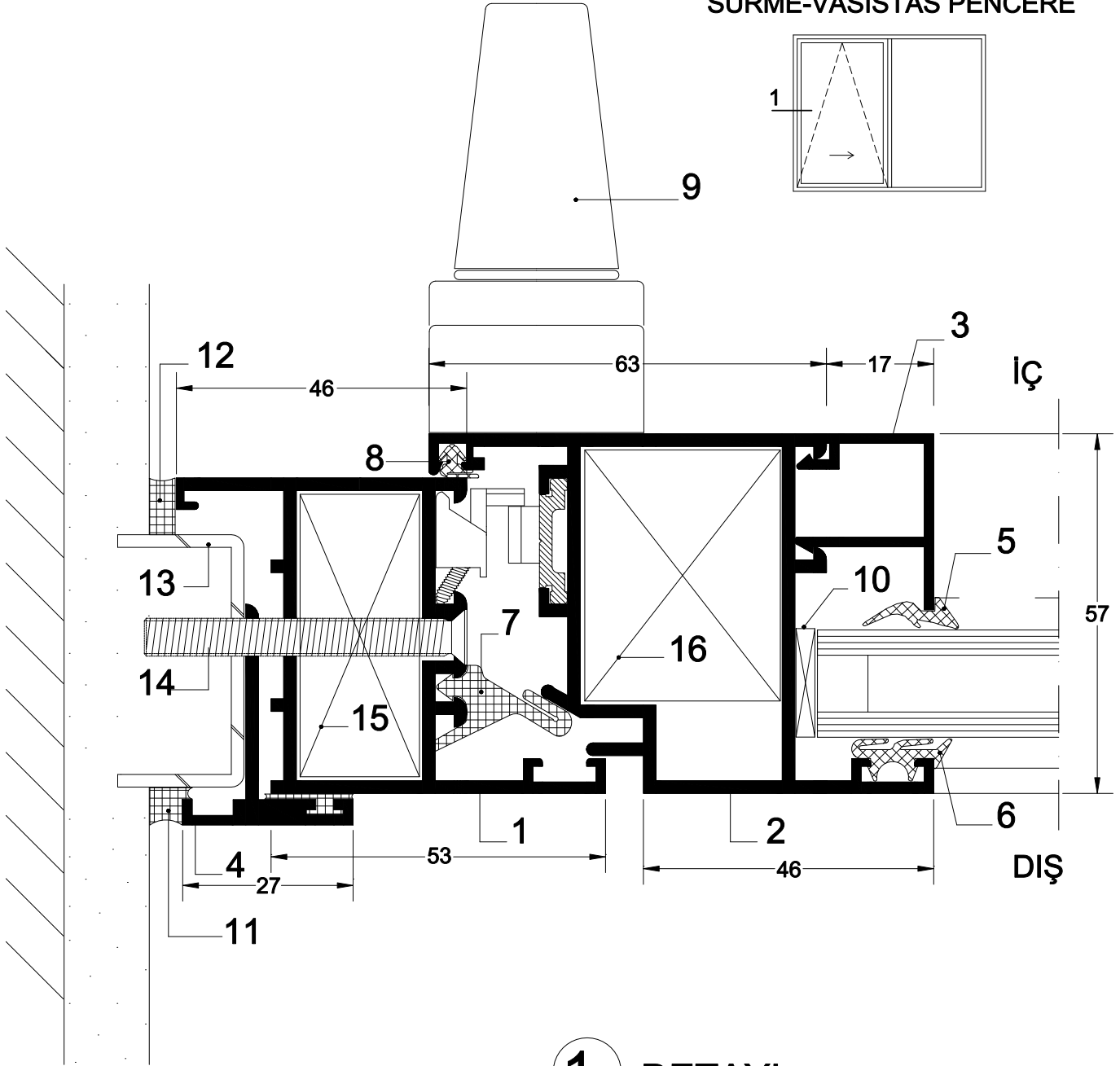
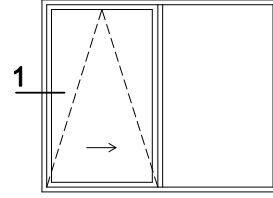
1 DETAYI

1. Kasa Profili	99-1037	8. Kanat Kulak Lastik Fitili	2036
2. Kanat Profili	99-1039	9. İspanyolet Kol	1314-1264 veya 1316-1268
3. Cam Çita Profili	88-010	10. Cam Takozu YSP 05	
4. Kasa T'si	88-027	11. Silikon	
5. İç Cam Fitili	2009-A	12. 602 Çekomastik (Beyaz - Kahverengi - Siyah)	
6. Dış Cam Fitili	2037	13. Korkasa	
7. Kasa Takoz Fitili	2197	14. Vida 5.5x50 YHB-A2	
		15. Köşe Takozu 93-517 (45.5mm)	
		16. Köşe Takozu 99-1054 (40.5mm)	

SÜRME-VASİSTAS PENCERE

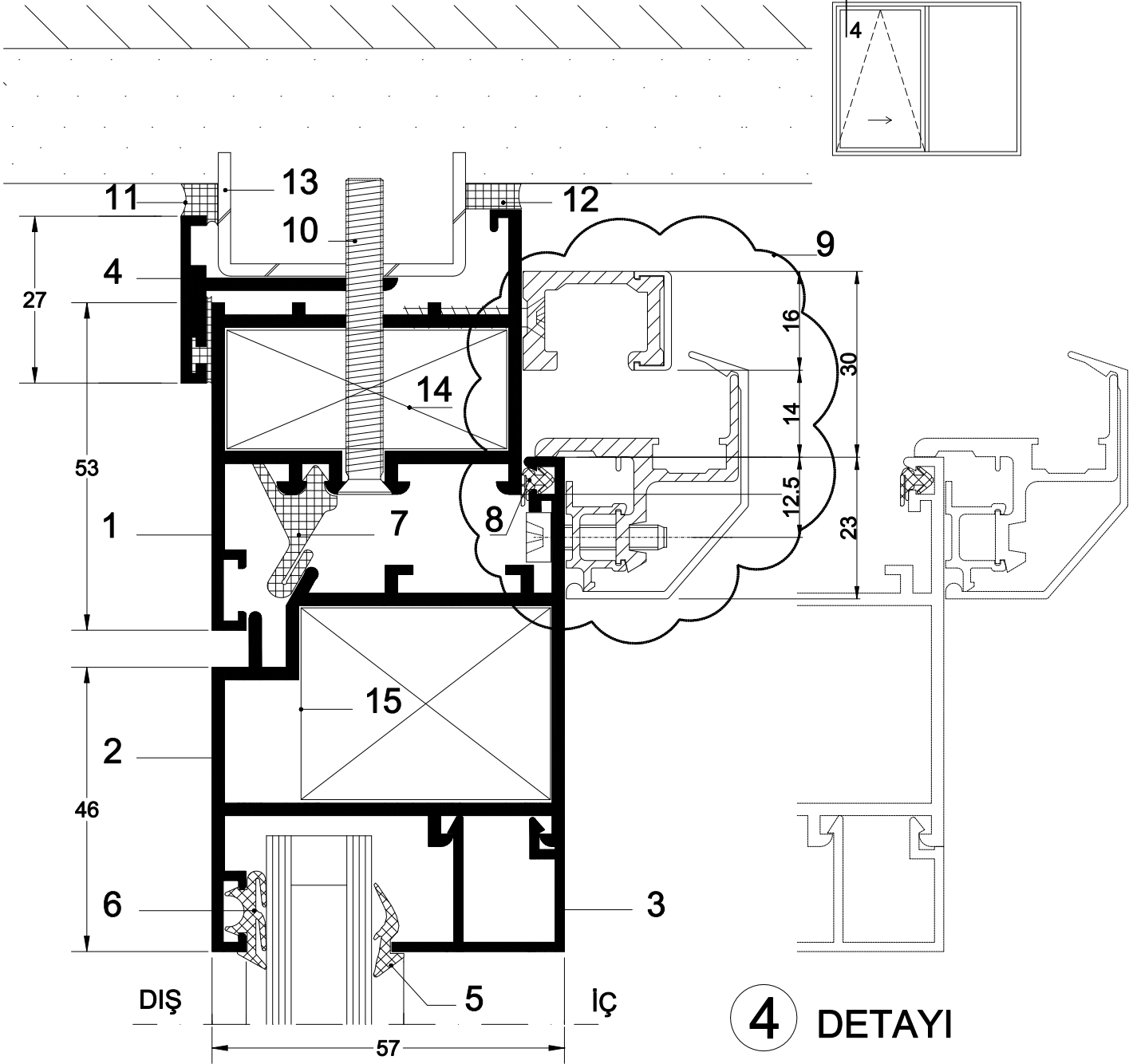

- | | | | |
|----------------------|---------|---|------|
| 1. Kasa Profili | 99-1037 | 8. Kanat Kulak Lastik Fitili | 2036 |
| 2. Kanat Profili | 99-1039 | 9. Siegenia Sürme Mekanizması | |
| 3. Cam Çıta Profili | 88-010 | 10. Vida 5.5x50 YHB-A2 | |
| 4. Kasa T'si | 88-027 | 11. Silikon | |
| 5. İç Cam Fitili | 2009-A | 12. 602 Çekomastik (Beyaz - Kahverengi - Siyah) | |
| 6. Dış Cam Fitili | 2037 | 13. Körkasa | |
| 7. Kasa Takoz Fitili | 2197 | 14. Köşe Takozu 93-517 (45.5mm) | |
| | | 15. Köşe Takozu 99-1054 (40.5mm) | |

SÜRME-VASİSTAS PENCERE

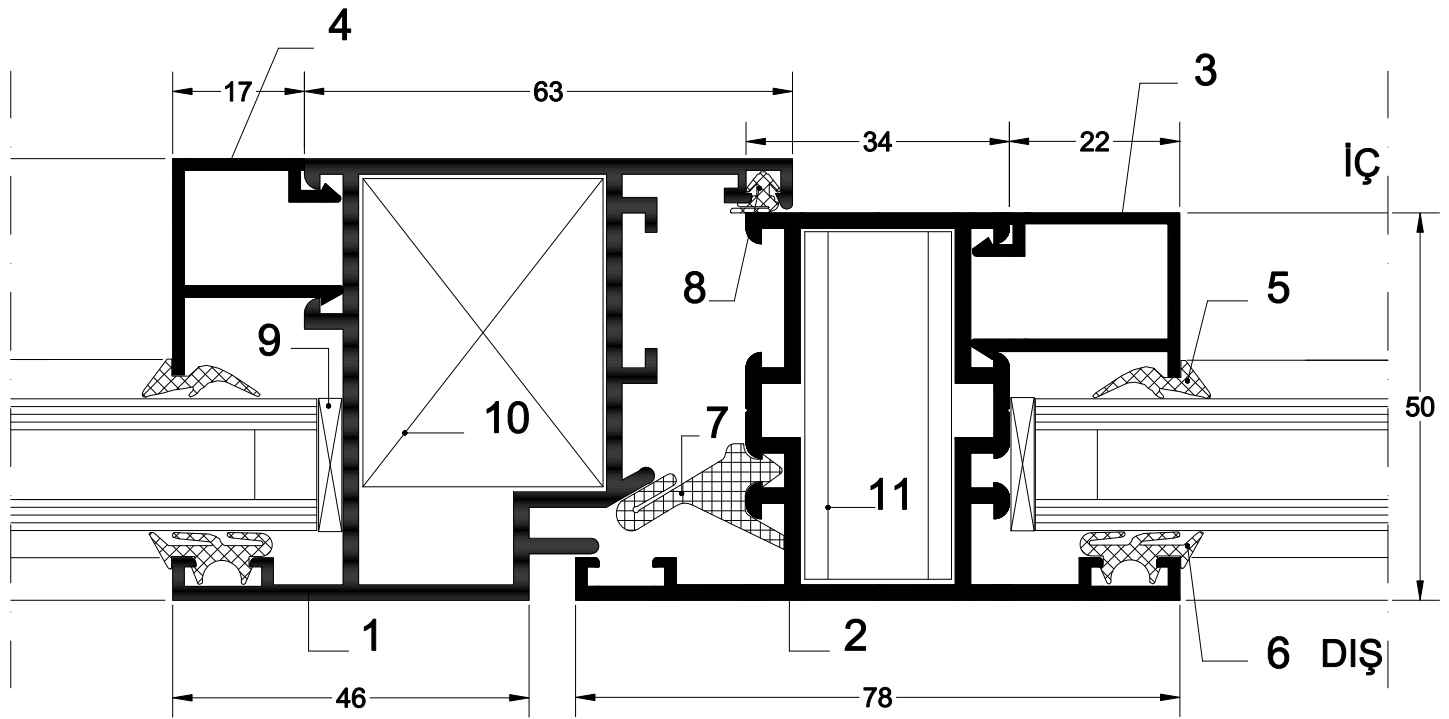
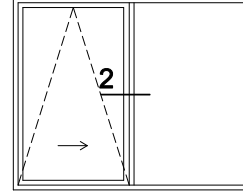

2 DETAYI

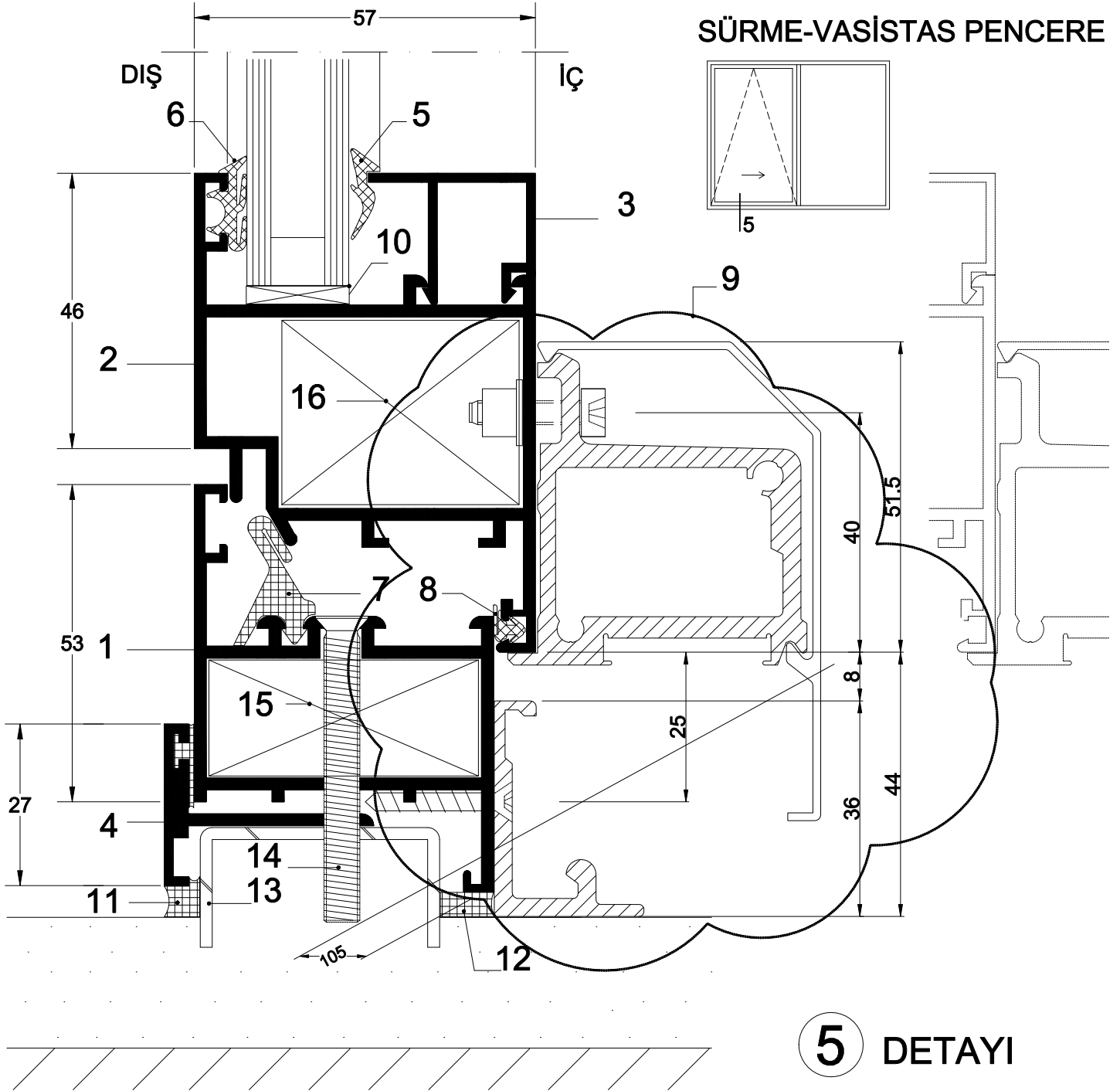
1. Kanat Profili	99-1039	7. Kasa Takoz Fiteli	2197
2. Orta Kayıt Profili	99-1036	8. Kanat Kulak Lastik Fiteli	2036
3. Cam Çıta Profili	88-011	9. Cam Takoza YHB 05	
4. Cam Çıta Profili	88-010	10. Köşe Takoza	99-1054 (40.5mm)
5. İç Cam Fiteli	2009-A	11. Çektirme Profili	88-031 (45.5mm)
6. Dış Cam Fiteli	2037		

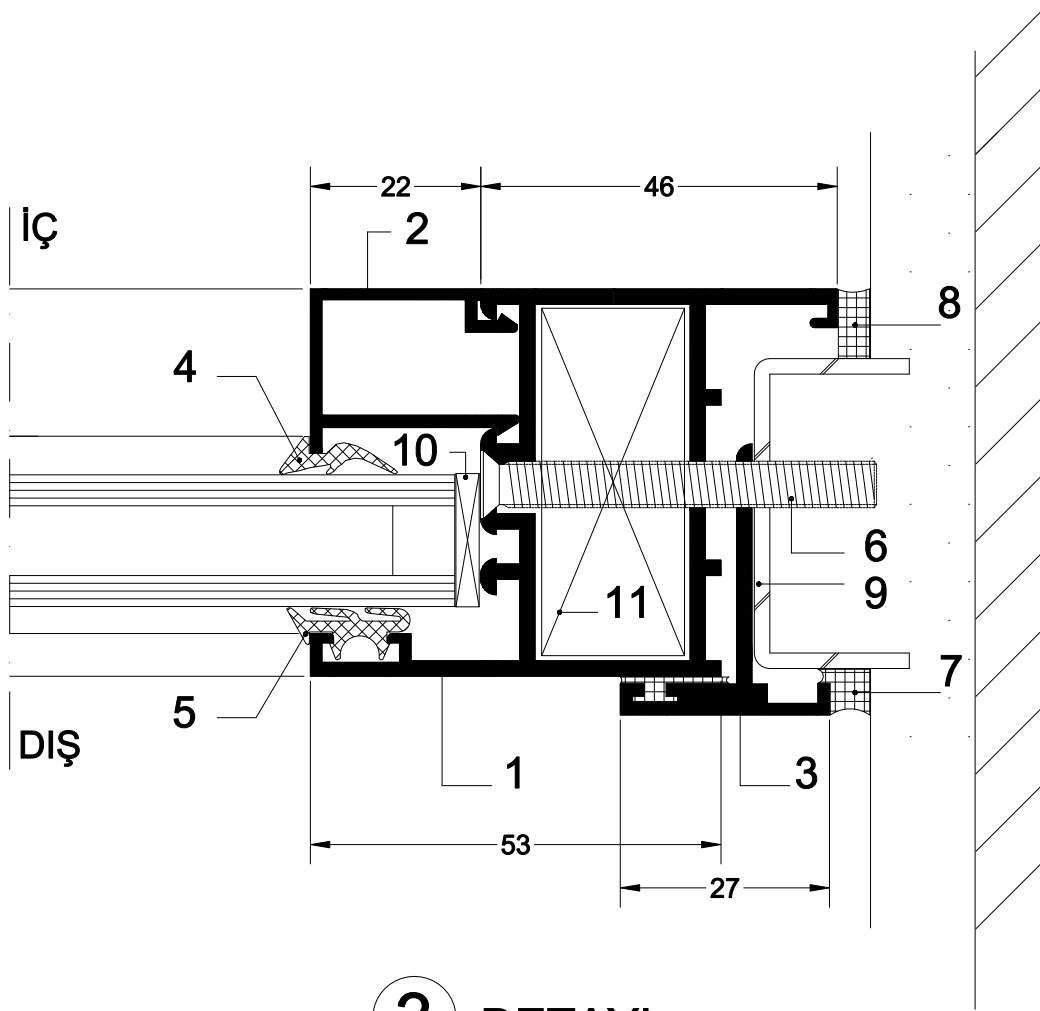
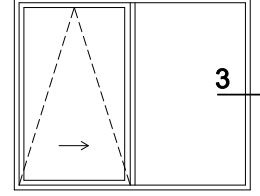

- | | | | |
|-----------------------|---------|---|------|
| 1. Kasa Profili | 99-1037 | 8. Kanat Kulak Lastik Fitili | 2036 |
| 2. Kanat Profili | 99-1039 | 9. Siegenia Sürme Mekanizması | |
| 3. Cam Çıta Profili | 88-010 | 10. Cam Takozu YSP 05 | |
| 4. Kasa T'si | 88-027 | 11. Silikon | |
| 5. İç Cam Fitili | 2009-A | 12. 602 Çekomastik (Beyaz - Kahverengi - Siyah) | |
| 6. Dış Cam Fitili | 2037 | 13. Körkasa | |
| 7. Kasa Takoza Fitili | 2197 | 14. Vida 5.5x50 YHB-A2 | |
| | | 15. Köşe Takoza 93-517 (45.5mm) | |
| | | 16. Köşe Takoza 99-1054 (40.5mm) | |

SÜRME-VASİSTAS PENCERE

3 DETAYI

1. Kasa Profili	99-1037	6. Vida 5.5x50 YHB-A2
2. Cam Çıta Profili	88-011	7. Silikon
3. Kasa T'si	88-027	8. 602 Çekomastik (Beyaz - Kahverengi - Siyah)
4. İç Cam Fitili	2009-A	9. Korkasa
5. Dış Cam Fitili	2037	10. Cam Takoza YHB 05
		11. Köşe Takoza 93-517 (45.5mm)